

The Courses & Distances  
Down the River are

- N. 54. E. 32 —
- N. 25. E. 14
- N. 5. W. 12
- N. 45. W. 13
- N. 67. W. 50
- N. 43. W. 80
- N. 20. W. 24
- N. 8. W. 103
- N. 10 E 16 W. α

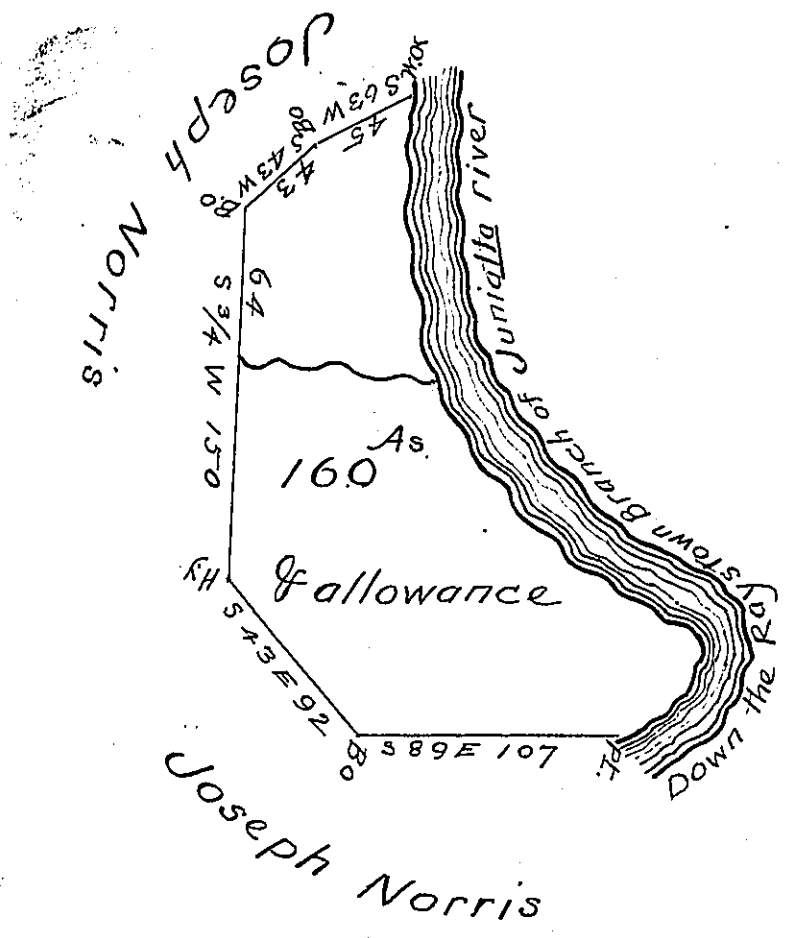

SITUATE in Hopewell Township Huntingdon County  
 Containing 160 Acres of allowance of six per cent  
 for Roads &c. Surveyed the 20<sup>th</sup> day of March 1832  
 In pursuance of a Warrant to Thomas Enyeart Exr  
 of Elizabeth Enyeart Exec<sup>trix</sup> of William Enyeart  
 Decsd. in trust &c. dated 3<sup>d</sup> March 1832.

W<sup>m</sup> Reed D.S.

To Jacob Spangler Esqr. }  
 Surveyor General }

IN TESTIMONY that the above is a copy of the original remaining on file in  
 the Department of Internal Affairs of Pennsylvania, made  
 conformably to an Act of Assembly approved the 16th day of  
 February, 1833, I have hereunto set my Hand and caused  
 the Seal of said Department to be affixed at Harrisburg,  
 this sixteenth day of August 1904.

*Loac B. Brown*  
 Secretary of Internal Affairs.